

AVAILABLE FOR LICENSING:

LAB-STILL: Portable High Purity Distilled Water

(Also suitable for drinking water if trace minerals are added back in.)

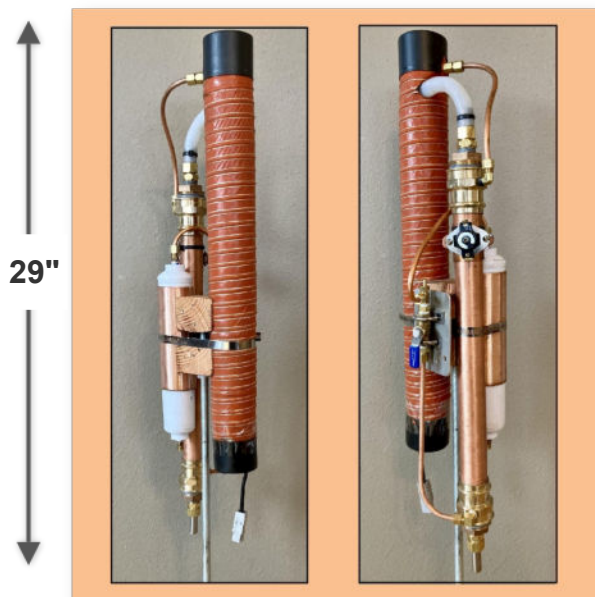

A Lean Manufacturing Dream Product. Easy to Construct in a Small Facility.

- **Self-cleaning** design eliminates mineral build up
- Produces high quality distilled water.
- The **15 LB.** unit is nature's hydrological cycle in a bottle.
- Pre- and post- activated charcoal filtration compliments the distillation process.
- Removes radioactive particles and PFAS (The so-called Forever Chemicals).
- At **29"** in height, the machine is easily wall mounted, placed on a counter top, or on the back of a door.
- Suitable for mobile laboratory work.

Ruggedized, Self-Cleaning Water Distiller

Powered By Any Current: AC or DC

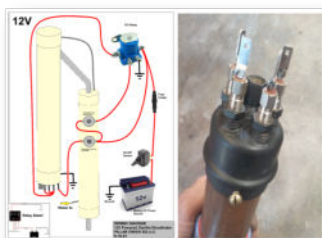

- No microprocessor. Simple chip-free controls.
- Uses electrical current from Solar, RV Charging, and Utility Power.
- Low power requirement: 500 to 1500 Watts.
- .5 to .7 GPH production.

Primarily Constructed of Copper



- Quartz and Borosilicate glass condenser tubes are available.
- Competitive water reservoir designs **insure** the distillate is quickly re-contaminated by airborne dust, pet dander, mold and detergents.
- **Our reservoir eliminates air-borne re-contamination.**

Ease Of Manufacture And Assembly



- Simple construction of durable antimicrobial copper. Unlike stainless steel, copper is easy to form, and gentle on tooling.
- Construction requires no special tooling or expensive equipment.

**Pillar Creek
Equipment LLC**
Ben L. Evridge



PO Box 670
Carlsborg, WA. USA
pillarcreek@outlook.com
<https://virtualdiesel.com>
(Copyright 2024-Ben L Evridge)

LAB-STILL: Provides Ease of Manufacture

Manufacturing Features and Benefits:

- Straightforward fabrication, assembly, and testing.
- Minimal facility floor space is required. Two workers with 280 square feet of space and work stations around the outer perimeter can work in a sequential, circular pattern producing eight machines per shift.
- Sales of the machine present opportunity for later sales of related accessories, such as the improved water reservoir, pre- and post-distillation filters.
- The common and inexpensive nature of the copper materials enables local procurement and flexible production according to sales demand.
- Safe for personnel to build.
- No toxic materials are used in the manufacturing process.
- The simple design minimizes future product warranty costs.
- Simple, chip-free electrical system and controls.
- We provide assembly training and help with workspace set up.
- All components and materials are of US manufacture.
- Available for licensing.



Lab-Still In White Birch Display

Patent Pending

Est. Retail Price: \$2350

Current Cost To Produce is \$710